

247 Kings Road, Chorlton, Manchester, M21 0XG



JP&Brimelow
ESTATE AGENTS

Offers In The Region Of £450,000

 3  1  2  D

VIDEO TOUR AVAILABLE A well-presented THREE BEDROOMED, bay fronted, traditional, semi-detached property. Positioned in a highly popular residential area off St Werburghs Road here in Chorlton. Within a short walk of the popular bars/restaurants/café in Chorlton. Chorlton Park, primary/secondary schools nearby and the Metrolink station giving you direct access into Manchester city centre/Media City/International Airport. Whalley Range Tennis & Cricket club are nearby with Hough End playing fields also close by. The property comprises; a porch, entrance Hall, a lounge with a bay window to the front aspect, a dining room, useful understairs storage and a fully fitted kitchen with access out into the rear enclosed garden. To the first floor there is a landing leading to three bedrooms two benefitting from built in wardrobes. A white three-piece bathroom completes this lovely home. The property benefits from gas fired central heating, a driveway providing off road parking and a large rear enclosed garden. OFFERED WITH NO VENDOR CHAIN.





EPC Chart

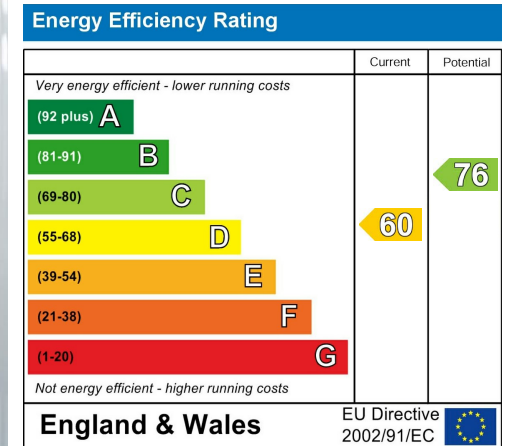

Tenure: **Freehold** Council Tax Band: **C**

Ground Floor

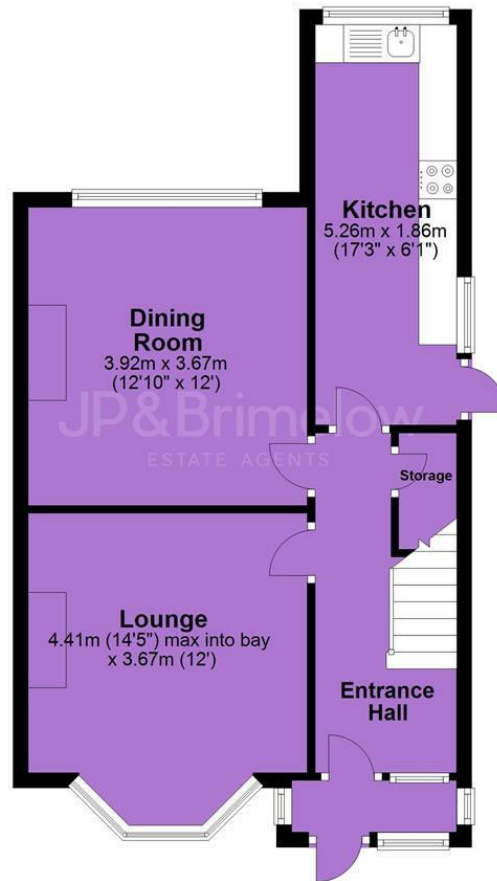

First Floor

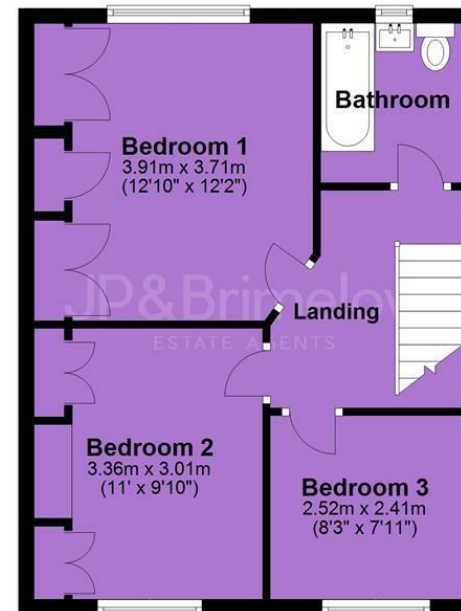

JP & Brimelow Estate Agents Ltd
430 Barlow Moor Road, Manchester, M21 8AD
Tel: 0161 8822233
E: sales@jpbrimelow.co.uk www.jpandbrimelow.co.uk



JP & Brimelow
ESTATE AGENTS

NOTICE: JP & Brimelow Estate Agents Ltd for themselves and for the vendors or lessors of this property whose agents they are give notice that:

- (i) the particulars are set out as a general outline only for the guidance of intending purchasers or lessees, and do not constitute, nor constitute part of, an offer or contract;
- (ii) all descriptions, dimensions, references to the condition and necessary permissions for use and occupation, and other details are given in good faith and are believed to be correct but any intending purchasers or tenants should not rely on them as statements or representations of fact but must satisfy themselves by inspection or otherwise as to the correctness of each of them;
- (iii) no person in the employment of JP & Brimelow Estate Agents Ltd has any authority to make or give any representation or warranty whatever in relation to this property.

jpandbrimelowestateagents

@jpandbrimelow